

■ 工字型电感器

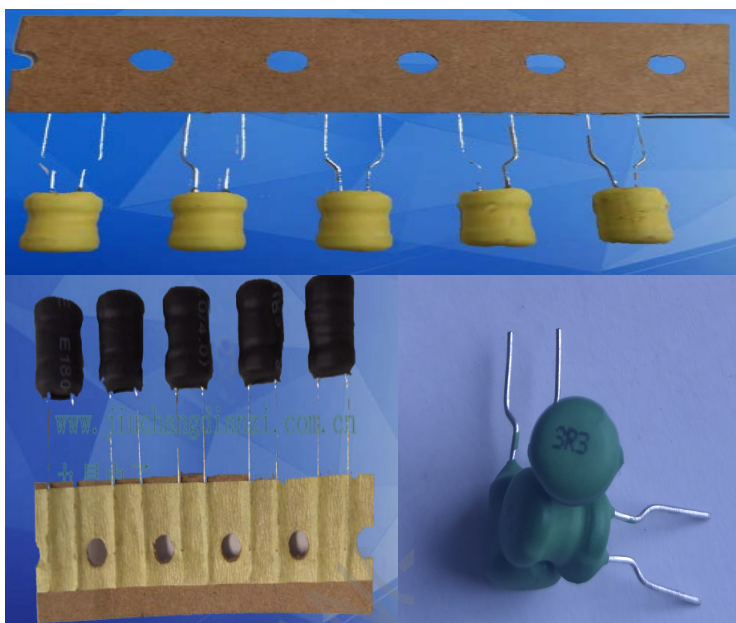

● 产品介绍

九昌工字电感 LGB 系列电感器又称为：扼流圈、阻流线圈、尖峰抑制线圈,用来限制交流电通过的线圈，分高频阻流圈和低频阻流圈。采用开磁路构造设计，有结构性佳、体积小、高 Q 值、低成本等特点，适用于笔记型计算机、喷墨打印机、复印机、显示监视器、手机、宽带调制解调器、游戏机、彩色电视、录放机、摄影机、微波炉、照明设备、汽车电子产品等。

九昌电感 LGB 系列电感器规格齐全，具有质量因素好，自共振频率高，可获得较大的感应电流，漏磁小等优点。用 PVC 或 UL 热缩套管保护，有立式和卧式结构可共选择。

九昌电感 LGB 系列电感器，符合 RoHS 标准，无铅焊接技术及 100% 无铅，并提供更有竞争力的价格和快速交货服务。若需特殊规格型式，可来图来样开模定制。

LGB工字型电感器 图示和尺寸: (单位mm)

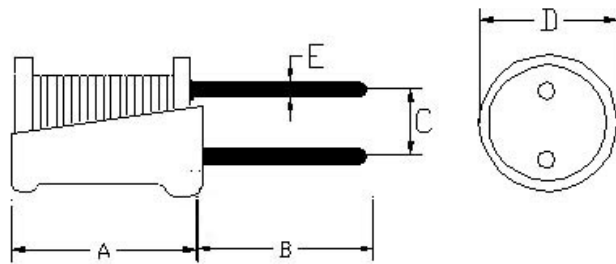

P/N 料号	A (MAX)	B (MIN)	C	D (MAX)	E (MAX)
0406	8.0	5.0	2.0±0.5	5.0	0.5±0.1
0507	9.0	5.0	2.5±0.5	6.0	0.6±0.1
0608	10.0	5.0	3.0±0.5	7.0	0.6±0.1
0610	12.0	5.0	3.0±0.5	7.0	0.6±0.1
0810	12.5	5.0	5.0±0.5	9.0	0.65±0.1
0912	15.0	5.0	5.0±0.5	11.0	0.6±0.1
1012	15.0	5.0	7.0±1.0	12.0	0.8±0.1
1016	19.0	5.0	6.0±1.0	12.0	0.8±0.1
1415	18.0	5.0	7.5±1.0	16.0	0.8±0.1

LGB工字型电感器 料号标识

LGB	0608		—	102	K		—	TP/PIN	
①	②			③	④			⑤	
类型	磁芯尺寸 (单位: mm)			电感值	误差值			编带或剪脚	
LGB	0406	4X6		R10	0.10μH	J	5%	TP	打编带
	0608	6X8		1R0	1.00μH	K	10%	PIN	要剪脚备注脚长
	0810	8X10		100	10.00μH	M	20%	—	不剪脚不编带
	0912	9X12		101	100.00μH				
	1012	10X12		102	1000.00μH				
	1016	10X16							
	1415	14X15							
备注	其它特殊规格详见磁芯规格表								

LGB0406 电气特性参数

料号	电感量 uH	测试频率	直流电阻 Ω	额定电流 mA
LGB0406 - 1R0M	1.0	1KHz/0.3V	0.030	3000
LGB0406 - 1R5M	1.5	1KHz/0.3V	0.035	2800
LGB0406 - 2R2M	2.2	1KHz/0.3V	0.045	2500
LGB0406 - 2R7M	2.7	1KHz/0.3V	0.050	2500
LGB0406 - 3R9M	3.9	1KHz/0.3V	0.055	2200
LGB0406 - 5R6M	5.6	1KHz/0.3V	0.070	1800
LGB0406 - 8R2M	8.2	1KHz/0.3V	0.090	1500
LGB0406 - 100K	10	1KHz/0.3V	0.11	1400
LGB0406 - 120K	12	1KHz/0.3V	0.14	1200
LGB0406 - 180K	18	1KHz/0.3V	0.18	1000
LGB0406 - 220K	22	1KHz/0.3V	0.25	900
LGB0406 - 270K	27	1KHz/0.3V	0.37	800
LGB0406 - 330K	33	1KHz/0.3V	0.42	700
LGB0406 - 390K	39	1KHz/0.3V	0.45	700
LGB0406 - 470K	47	1KHz/0.3V	0.50	600
LGB0406 - 560K	56	1KHz/0.3V	0.56	600
LGB0406 - 680K	68	1KHz/0.3V	0.63	550
LGB0406 - 820K	82	1KHz/0.3V	0.77	500
LGB0406 - 101K	100	1KHz/0.3V	0.85	400
LGB0406 - 121K	120	1KHz/0.3V	1.30	400
LGB0406 - 151K	150	1KHz/0.3V	1.40	300
LGB0406 - 181K	180	1KHz/0.3V	2.20	300
LGB0406 - 221K	220	1KHz/0.3V	2.50	280
LGB0406 - 271K	270	1KHz/0.3V	2.70	250
LGB0406 - 331K	330	1KHz/0.3V	3.00	220
LGB0406 - 391K	390	1KHz/0.3V	3.40	210
LGB0406 - 471K	470	1KHz/0.3V	3.90	200
LGB0406 - 561K	560	1KHz/0.3V	5.00	160
LGB0406 - 681K	680	1KHz/0.3V	7.00	150
LGB0406 - 821K	820	1KHz/0.3V	7.70	140
LGB0406 - 102K	1000	1KHz/0.3V	8.70	120
LGB0406 - 122K	1200	1KHz/0.3V	10.0	115
LGB0406 - 152K	1500	1KHz/0.3V	13.0	110
LGB0406 - 182K	1800	1KHz/0.3V	15.0	100
LGB0406 - 222K	2200	1KHz/0.3V	17.0	95
LGB0406 - 272K	2700	1KHz/0.3V	19.0	90
LGB0406 - 332K	3300	1KHz/0.3V	26.0	83
LGB0406 - 392K	3900	1KHz/0.3V	30.0	76
LGB0406 - 472K	4700	1KHz/0.3V	45.0	70
LGB0406 - 562K	5600	1KHz/0.3V	48.0	62
LGB0406 - 682K	6800	1KHz/0.3V	56.0	56
LGB0406 - 822K	8200	1KHz/0.3V	62.0	52
LGB0406 - 103K	10000	1KHz/0.3V	72.0	47
LGB0406 - 123K	12000	1KHz/0.3V	80.0	40
LGB0406 - 153K	15000	1KHz/0.3V	120.0	35
LGB0406 - 183K	18000	1KHz/0.3V	135.0	30
LGB0406 - 223K	22000	1KHz/0.3V	160.0	24
LGB0406 - 253K	25000	1KHz/0.3V	180.0	20

LGB0507 电气特性参数

料号	电感量 μH	测试频率	直流电阻 Ω	额定电流 mA
LGB0507 - 1R0M	1.0	1KHz/0.3V	0.025	4000
LGB0507 - 1R5M	1.5	1KHz/0.3V	0.030	2900
LGB0507 - 2R2M	2.2	1KHz/0.3V	0.040	2500
LGB0507 - 2R7M	2.7	1KHz/0.3V	0.045	2500
LGB0507 - 3R9M	3.9	1KHz/0.3V	0.050	2200
LGB0507 - 5R6M	5.6	1KHz/0.3V	0.060	1800
LGB0507 - 8R2M	8.2	1KHz/0.3V	0.080	1500
LGB0507 - 100K	10	1KHz/0.3V	0.10	1400
LGB0507 - 120K	12	1KHz/0.3V	0.13	1200
LGB0507 - 180K	18	1KHz/0.3V	0.17	1000
LGB0507 - 220K	22	1KHz/0.3V	0.25	900
LGB0507 - 270K	27	1KHz/0.3V	0.36	800
LGB0507 - 330K	33	1KHz/0.3V	0.40	700
LGB0507 - 390K	39	1KHz/0.3V	0.42	700
LGB0507 - 470K	47	1KHz/0.3V	0.49	600
LGB0507 - 560K	56	1KHz/0.3V	0.52	600
LGB0507 - 680K	68	1KHz/0.3V	0.62	550
LGB0507 - 820K	82	1KHz/0.3V	0.76	500
LGB0507 - 101K	100	1KHz/0.3V	0.84	400
LGB0507 - 121K	120	1KHz/0.3V	1.10	400
LGB0507 - 151K	150	1KHz/0.3V	1.00	300
LGB0507 - 181K	180	1KHz/0.3V	2.10	300
LGB0507 - 221K	220	1KHz/0.3V	2.30	280
LGB0507 - 271K	270	1KHz/0.3V	2.50	250
LGB0507 - 331K	330	1KHz/0.3V	2.40	220
LGB0507 - 391K	390	1KHz/0.3V	3.20	210
LGB0507 - 471K	470	1KHz/0.3V	3.80	200
LGB0507 - 561K	560	1KHz/0.3V	4.90	160
LGB0507 - 681K	680	1KHz/0.3V	7.00	150
LGB0507 - 821K	820	1KHz/0.3V	7.70	140
LGB0507 - 102K	1000	1KHz/0.3V	8.70	120
LGB0507 - 122K	1200	1KHz/0.3V	10.0	115
LGB0507 - 152K	1500	1KHz/0.3V	13.0	110
LGB0507 - 182K	1800	1KHz/0.3V	15.0	100
LGB0507 - 222K	2200	1KHz/0.3V	17.0	95
LGB0507 - 272K	2700	1KHz/0.3V	19.0	90
LGB0507 - 332K	3300	1KHz/0.3V	26.0	83
LGB0507 - 392K	3900	1KHz/0.3V	30.0	76
LGB0507 - 472K	4700	1KHz/0.3V	45.0	70
LGB0507 - 562K	5600	1KHz/0.3V	48.0	62
LGB0507 - 682K	6800	1KHz/0.3V	56.0	56
LGB0507 - 822K	8200	1KHz/0.3V	62.0	52
LGB0507 - 103K	10000	1KHz/0.3V	72.0	47
LGB0507 - 123K	12000	1KHz/0.3V	80.0	40
LGB0507 - 153K	15000	1KHz/0.3V	120.0	35
LGB0507 - 183K	18000	1KHz/0.3V	135.0	30
LGB0507 - 223K	22000	1KHz/0.3V	160.0	24
LGB0507 - 253K	25000	1KHz/0.3V	180.0	20

LGB0608 电气特性参数

料号	电感量 uH	测试频率	直流电阻 Ω	额定电流 mA
LGB0608 - 2R2M	2.2	1KHz/0.3V	0.015	2600
LGB0608 - 8R2M	8.2	1KHz/0.3V	0.035	1200
LGB0608 - 100K	10	1KHz/0.3V	0.045	1000
LGB0608 - 150K	15	1KHz/0.3V	0.055	900
LGB0608 - 180K	18	1KHz/0.3V	0.090	900
LGB0608 - 220K	22	1KHz/0.3V	0.095	800
LGB0608 - 330K	33	1KHz/0.3V	0.125	700
LGB0608 - 470K	47	1KHz/0.3V	0.16	600
LGB0608 - 560K	56	1KHz/0.3V	0.18	600
LGB0608 - 680K	68	1KHz/0.3V	0.20	560
LGB0608 - 820K	82	1KHz/0.3V	0.27	480
LGB0608 - 101K	100	1KHz/0.3V	0.31	450
LGB0608 - 121K	120	1KHz/0.3V	0.37	430
LGB0608 - 151K	150	1KHz/0.3V	0.47	400
LGB0608 - 181K	180	1KHz/0.3V	0.54	400
LGB0608 - 271K	270	1KHz/0.3V	0.83	320
LGB0608 - 331K	330	1KHz/0.3V	0.95	300
LGB0608 - 391K	390	1KHz/0.3V	1.22	270
LGB0608 - 471K	470	1KHz/0.3V	1.63	250
LGB0608 - 561K	560	1KHz/0.3V	1.8	220
LGB0608 - 681K	680	1KHz/0.3V	2.1	200
LGB0608 - 821K	820	1KHz/0.3V	2.9	180
LGB0608 - 102K	1000	1KHz/0.3V	3.2	170
LGB0608 - 122K	1200	1KHz/0.3V	3.5	160
LGB0608 - 152K	1500	1KHz/0.3V	4.5	155
LGB0608 - 182K	1800	1KHz/0.3V	5.0	150
LGB0608 - 222K	2200	1KHz/0.3V	6.8	140
LGB0608 - 272K	2700	1KHz/0.3V	7.2	125
LGB0608 - 392K	3900	1KHz/0.3V	11.7	105
LGB0608 - 472K	4700	1KHz/0.3V	13.6	95
LGB0608 - 562K	5600	1KHz/0.3V	16.6	85
LGB0608 - 682K	6800	1KHz/0.3V	19.6	80
LGB0608 - 822K	8200	1KHz/0.3V	25.2	70
LGB0608 - 103K	10000	1KHz/0.3V	29.5	65
LGB0608 - 123K	12000	1KHz/0.3V	33.8	60
LGB0608 - 153K	15000	1KHz/0.3V	45.4	55
LGB0608 - 183K	18000	1KHz/0.3V	50.4	50
LGB0608 - 253K	25000	1KHz/0.3V	85.5	40
LGB0608 - 303K	30000	1KHz/0.3V	91.5	40
LGB0608 - 333K	33000	1KHz/0.3V	98.5	35
LGB0608 - 393K	39000	1KHz/0.3V	140	32
LGB0608 - 503K	50000	1KHz/0.3V	170	29
LGB0608 - 563K	56000	1KHz/0.3V	250	28
LGB0608 - 683K	68000	1KHz/0.3V	282	25
LGB0608 - 823K	82000	1KHz/0.3V	312	23
LGB0608 - 104K	100000	1KHz/0.3V	380	20
LGB0608 - 124K	120000	1KHz/0.3V	430	18
LGB0608 - 154K	150000	1KHz/0.3V	520	16

LGB0610 电气特性参数

料号	电感量 uH	测试频率	直流电阻 Ω	额定电流 mA
LGB0610 - 2R2M	2.2	1KHz/0.3V	0.010	3000
LGB0610 - 8R2M	8.2	1KHz/0.3V	0.030	1400
LGB0610 - 100K	10	1KHz/0.3V	0.040	1000
LGB0610 8 - 150K	15	1KHz/0.3V	0.050	900
LGB0610 - 180K	18	1KHz/0.3V	0.090	900
LGB0610 - 220K	22	1KHz/0.3V	0.095	800
LGB0610 - 330K	33	1KHz/0.3V	0.125	700
LGB0610 - 470K	47	1KHz/0.3V	0.16	600
LGB0610 - 560K	56	1KHz/0.3V	0.18	600
LGB0610 - 680K	68	1KHz/0.3V	0.20	560
LGB0610 - 820K	82	1KHz/0.3V	0.27	480
LGB0610 - 101K	100	1KHz/0.3V	0.31	450
LGB0610 - 121K	120	1KHz/0.3V	0.37	430
LGB0610 - 151K	150	1KHz/0.3V	0.47	400
LGB0610 - 181K	180	1KHz/0.3V	0.54	400
LGB0610 - 271K	270	1KHz/0.3V	0.83	320
LGB0610 - 331K	330	1KHz/0.3V	0.95	300
LGB0610 - 391K	390	1KHz/0.3V	1.22	270
LGB0610 - 471K	470	1KHz/0.3V	1.61	250
LGB0610 - 561K	560	1KHz/0.3V	1.7	220
LGB0610 - 681K	680	1KHz/0.3V	2.1	200
LGB0610 - 821K	820	1KHz/0.3V	2.9	180
LGB0610 - 102K	1000	1KHz/0.3V	3.2	170
LGB0610 - 122K	1200	1KHz/0.3V	3.5	160
LGB0610 - 152K	1500	1KHz/0.3V	4.5	155
LGB0610 - 182K	1800	1KHz/0.3V	5.0	150
LGB0610 - 222K	2200	1KHz/0.3V	6.8	140
LGB0610 - 272K	2700	1KHz/0.3V	7.2	125
LGB0610 - 392K	3900	1KHz/0.3V	11.7	105
LGB0610 - 472K	4700	1KHz/0.3V	13.6	95
LGB0610 - 562K	5600	1KHz/0.3V	16.6	85
LGB0610 - 682K	6800	1KHz/0.3V	19.6	80
LGB0610 - 822K	8200	1KHz/0.3V	25.2	70
LGB0610 - 103K	10000	1KHz/0.3V	29.5	65
LGB0610 - 123K	12000	1KHz/0.3V	33.8	60
LGB0610 - 153K	15000	1KHz/0.3V	45.4	55
LGB0610 - 183K	18000	1KHz/0.3V	50.4	50
LGB0610 - 253K	25000	1KHz/0.3V	85.5	40
LGB0610 - 303K	30000	1KHz/0.3V	91.5	40
LGB0610 - 333K	33000	1KHz/0.3V	98.5	35
LGB0610 - 393K	39000	1KHz/0.3V	140	32
LGB0610 - 503K	50000	1KHz/0.3V	170	29
LGB0610 - 563K	56000	1KHz/0.3V	250	28
LGB0610 - 683K	68000	1KHz/0.3V	282	25
LGB0610 - 823K	82000	1KHz/0.3V	312	23
LGB0610 - 104K	100000	1KHz/0.3V	380	20
LGB0610 - 124K	120000	1KHz/0.3V	420	18
LGB0610 - 154K	150000	1KHz/0.3V	510	16

LGB0810 电气特性参数

料号	电感量 uH	测试频率	直流电阻 Ω	额定电流 mA
LGB0810 - 1R0M	1.0	1KHz/0.3V	0.015	4.50
LGB0810 - 4R7M	4.7	1KHz/0.3V	0.025	4.00
LGB0810 - 6R8M	6.8	1KHz/0.3V	0.025	4.00
LGB0810 - 100K	10	1KHz/0.3V	0.040	3.80
LGB0810 - 120K	12	1KHz/0.3V	0.040	3.20
LGB0810 - 150K	15	1KHz/0.3V	0.045	2.80
LGB0810 - 180K	18	1KHz/0.3V	0.060	2.50
LGB0810 - 220K	22	1KHz/0.3V	0.070	2.10
LGB0810 - 270K	27	1KHz/0.3V	0.085	2.00
LGB0810 - 330K	33	1KHz/0.3V	0.09	1.80
LGB0810 - 390K	39	1KHz/0.3V	0.10	1.60
LGB0810 - 470K	47	1KHz/0.3V	0.11	1.50
LGB0810 - 560K	56	1KHz/0.3V	0.15	1.30
LGB0810 - 680K	68	1KHz/0.3V	0.19	1.00
LGB0810 - 820K	82	1KHz/0.3V	0.21	0.90
LGB0810 - 101K	100	1KHz/0.3V	0.24	0.80
LGB0810 - 121K	120	1KHz/0.3V	0.26	0.80
LGB0810 - 151K	150	1KHz/0.3V	0.31	0.75
LGB0810 - 181K	180	1KHz/0.3V	0.38	0.70
LGB0810 - 221K	220	1KHz/0.3V	0.43	0.65
LGB0810 - 271K	270	1KHz/0.3V	0.49	0.63
LGB0810 - 331K	330	1KHz/0.3V	0.66	0.60
LGB0810 - 391K	390	1KHz/0.3V	0.79	0.58
LGB0810 - 471K	470	1KHz/0.3V	0.91	0.52
LGB0810 - 561K	560	1KHz/0.3V	1.13	0.50
LGB0810 - 681K	680	1KHz/0.3V	1.30	0.40
LGB0810 - 821K	820	1KHz/0.3V	1.53	0.30
LGB0810 - 102K	1000	1KHz/0.3V	1.80	0.27
LGB0810 - 152K	1500	1KHz/0.3V	2.40	230
LGB0810 - 182K	1800	1KHz/0.3V	2.80	210
LGB0810 - 222K	2200	1KHz/0.3V	3.30	190
LGB0810 - 272K	2700	1KHz/0.3V	5.00	170
LGB0810 - 332K	3300	1KHz/0.3V	5.60	150
LGB0810 - 392K	3900	1KHz/0.3V	6.20	140
LGB0810 - 472K	4700	1KHz/0.3V	7.00	130
LGB0810 - 562K	5600	1KHz/0.3V	9.10	120
LGB0810 - 682K	6800	1KHz/0.3V	10.0	110
LGB0810 - 822K	8200	1KHz/0.3V	15.0	100
LGB0810 - 103K	10000	1KHz/0.3V	22.0	90
LGB0810 - 123K	12000	1KHz/0.3V	25.0	73
LGB0810 - 153K	15000	1KHz/0.3V	29.0	68
LGB0810 - 183K	18000	1KHz/0.3V	38.1	66
LGB0810 - 223K	22000	1KHz/0.3V	44.9	59
LGB0810 - 253K	25000	1KHz/0.3V	50.3	56
LGB0810 - 303K	30000	1KHz/0.3V	55.7	52
LGB0810 - 333K	33000	1KHz/0.3V	64.2	48
LGB0810 - 393K	39000	1KHz/0.3V	74.2	42
LGB0810 - 473K	47000	1KHz/0.3V	96.4	38

LGB0912 电气特性参数

料号	电感量 uH	测试频率	直流电阻 Ω	额定电流 mA
LGB0912 - 1R0M	1.0	1KHz/0.3V	0.015	5000
LGB0912 - 1R5M	1.5	1KHz/0.3V	0.015	5000
LGB0912 - 1R8M	1.8	1KHz/0.3V	0.015	5000
LGB0912 - 2R2M	2.2	1KHz/0.3V	0.015	5000
LGB0912 - 3R3M	3.3	1KHz/0.3V	0.020	5000
LGB0912 - 3R9M	3.9	1KHz/0.3V	0.020	4800
LGB0912 - 4R7M	4.7	1KHz/0.3V	0.020	4500
LGB0912 - 5R6M	5.6	1KHz/0.3V	0.025	4000
LGB0912 - 6R8M	6.8	1KHz/0.3V	0.025	3900
LGB0912 - 8R2M	8.2	1KHz/0.3V	0.025	3500
LGB0912 - 100K	10	1KHz/0.3V	0.030	3400
LGB0912 - 120K	12	1KHz/0.3V	0.030	3200
LGB0912 - 150K	15	1KHz/0.3V	0.040	3000
LGB0912 - 180K	18	1KHz/0.3V	0.045	2800
LGB0912 - 220K	22	1KHz/0.3V	0.050	2700
LGB0912 - 270K	27	1KHz/0.3V	0.055	2500
LGB0912 - 330K	33	1KHz/0.3V	0.055	2500
LGB0912 - 390K	39	1KHz/0.3V	0.06	2000
LGB0912 - 470K	47	1KHz/0.3V	0.07	1800
LGB0912 - 560K	56	1KHz/0.3V	0.08	1700
LGB0912 - 680K	68	1KHz/0.3V	0.09	1500
LGB0912 - 820K	82	1KHz/0.3V	0.11	1400
LGB0912 - 101K	100	1KHz/0.3V	0.16	1200
LGB0912 - 121K	120	1KHz/0.3V	0.170	1100
LGB0912 - 151K	150	1KHz/0.3V	0.20	1000
LGB0912 - 181K	180	1KHz/0.3V	0.22	900
LGB0912 - 221K	220	1KHz/0.3V	0.26	800
LGB0912 - 271K	270	1KHz/0.3V	0.39	700
LGB0912 - 331K	330	1KHz/0.3V	0.45	500
LGB0912 - 391K	390	1KHz/0.3V	0.49	450
LGB0912 - 471K	470	1KHz/0.3V	0.62	430
LGB0912 - 561MK	560	1KHz/0.3V	0.64	400
LGB0912 - 681K	680	1KHz/0.3V	0.79	380
LGB0912 - 821K	820	1KHz/0.3V	1.34	350
LGB0912 - 102K	1000	1KHz/0.3V	1.82	300

LGB1012 电气特性参数

料号	电感量 uH	测试频率	直流电阻 Ω	额定电流 mA
LGB1012 - 1R0M	1.0	1KHz/0.3V	0.010	6000
LGB1012 - 1R5M	1.5	1KHz/0.3V	0.010	6000
LGB1012 - 1R8M	1.8	1KHz/0.3V	0.015	6000
LGB1012 - 2R7M	2.7	1KHz/0.3V	0.015	5500
LGB1012 - 3R3M	3.3	1KHz/0.3V	0.015	5500
LGB1012 - 3R9M	3.9	1KHz/0.3V	0.020	5000
LGB1012 - 4R7M	4.7	1KHz/0.3V	0.020	5000
LGB1012 - 5R6M	5.6	1KHz/0.3V	0.025	4800
LGB1012 - 6R8M	6.8	1KHz/0.3V	0.025	4800
LGB1012 - 8R2M	8.2	1KHz/0.3V	0.025	4500
LGB1012 - 100K	10	1KHz/0.3V	0.025	4500
LGB1012 - 120K	12	1KHz/0.3V	0.025	4300
LGB1012 - 150K	15	1KHz/0.3V	0.035	4300
LGB1012 - 180K	18	1KHz/0.3V	0.040	4000
LGB1012 - 220K	22	1KHz/0.3V	0.045	3700
LGB1012 - 270K	27	1KHz/0.3V	0.045	3500
LGB1012 - 330K	33	1KHz/0.3V	0.055	3000
LGB1012 - 390K	39	1KHz/0.3V	0.060	2500
LGB1012 - 470K	47	1KHz/0.3V	0.080	2300
LGB1012 - 560K	56	1KHz/0.3V	0.085	2000
LGB1012 - 680K	68	1KHz/0.3V	0.095	2000
LGB1012 - 820K	82	1KHz/0.3V	0.11	1800
LGB1012 - 101K	100	1KHz/0.3V	0.14	1700
LGB1012 - 121K	120	1KHz/0.3V	0.16	1500
LGB1012 - 151K	150	1KHz/0.3V	0.18	1400
LGB1012 - 181K	180	1KHz/0.3V	0.25	1300
LGB1012 - 221K	220	1KHz/0.3V	0.28	1000
LGB1012 - 271K	270	1KHz/0.3V	0.42	900
LGB1012 - 331K	330	1KHz/0.3V	0.54	800
LGB1012 - 391K	390	1KHz/0.3V	0.60	800
LGB1012 - 471K	470	1KHz/0.3V	0.66	700
LGB1012 - 561K	560	1KHz/0.3V	0.74	600
LGB1012 - 681K	680	1KHz/0.3V	0.84	500
LGB1012 - 821K	820	1KHz/0.3V	1.08	500
LGB1012 - 102K	1000	1KHz/0.3V	1.39	500

LGB1016 电气特性参数

料号	电感量 μH	测试频率	直流电阻 Ω	额定电流 mA
LGB1016 - 3R3M	3.3	1KHz/0.3V	0.015	8500
LGB1016 - 6R8M	6.8	1KHz/0.3V	0.025	7500
LGB1016 - 100K	10	1KHz/0.3V	0.030	7200
LGB1016 - 120K	12	1KHz/0.3V	0.030	7000
LGB1016 - 150K	15	1KHz/0.3V	0.035	6500
LGB1016 - 180K	18	1KHz/0.3V	0.035	6300
LGB1016 - 220K	22	1KHz/0.3V	0.045	5500
LGB1016 - 270K	27	1KHz/0.3V	0.050	4500
LGB1016 - 330K	33	1KHz/0.3V	0.070	4000
LGB1016 - 390K	39	1KHz/0.3V	0.070	3800
LGB1016 - 470K	47	1KHz/0.3V	0.070	3600
LGB1016 - 560K	56	1KHz/0.3V	0.080	3200
LGB1016 - 680K	68	1KHz/0.3V	0.090	3000
LGB1016 - 820K	82	1KHz/0.3V	0.095	2600
LGB1016 - 101K	100	1KHz/0.3V	0.12	2500
LGB1016 - 121K	120	1KHz/0.3V	0.14	2300
LGB1016 - 151K	150	1KHz/0.3V	0.17	2100
LGB1016 - 181K	180	1KHz/0.3V	0.19	2000
LGB1016 - 221K	220	1KHz/0.3V	0.25	1800
LGB1016 - 271K	270	1KHz/0.3V	0.34	1500
LGB1016 - 331K	330	1KHz/0.3V	0.45	1500
LGB1016 - 391K	390	1KHz/0.3V	0.51	1300
LGB1016 - 471K	470	1KHz/0.3V	0.56	1200
LGB1016 - 561K	560	1KHz/0.3V	0.64	1000
LGB1016 - 681K	680	1KHz/0.3V	0.71	1000
LGB1016 - 821K	820	1KHz/0.3V	1.01	900
LGB1016 - 102K	1	1KHz/0.3V	1.20	800
LGB1016 - 122K	1200	1KHz/0.3V	1.5	620
LGB1016 - 152K	1	1KHz/0.3V	1.7	550
LGB1016 - 182K	1800	1KHz/0.3V	1.8	490
LGB1016 - 222K	2	1KHz/0.3V	2.4	385
LGB1016 - 272K	2700	1KHz/0.3V	2.8	385
LGB1016 - 332K	3	1KHz/0.3V	3.7	300
LGB1016 - 392K	3900	1KHz/0.3V	5.0	250
LGB1016 - 472K	4	1KHz/0.3V	5.6	250
LGB1016 - 562K	5600	1KHz/0.3V	6.3	250
LGB1016 - 682K	6	1KHz/0.3V	8.4	190
LGB1016 - 822K	8200	1KHz/0.3V	9.6	190
LGB1016 - 103K	10	1KHz/0.3V	10.5	190
LGB1016 - 123K	12000	1KHz/0.3V	14.05	150
LGB1016 - 153K	15	1KHz/0.3V	20.5	120
LGB1016 - 183K	18000	1KHz/0.3V	27.5	95
LGB1016 - 223K	22	1KHz/0.3V	31.0	95
LGB1016 - 253K	25000	1KHz/0.3V	32.5	95
LGB1016 - 303K	30	1KHz/0.3V	35.5	95
LGB1016 - 333K	33000	1KHz/0.3V	40.0	95
LGB1016 - 393K	39	1KHz/0.3V	51.0	95
LGB1016 - 473K	47000	1KHz/0.3V	56.0	95

LGB1415 电气特性参数

料号	电感量 uH	测试频率	直流电阻 Ω	额定电流 mA
LGB1415-100K	10	1KHz/0.3V	0.015	7500
LGB1415-120K	12	1KHz/0.3V	0.016	7000
LGB1415-150K	15	1KHz/0.3V	0.017	6500
LGB1415-180K	18	1KHz/0.3V	0.019	6000
LGB1415-220K	22	1KHz/0.3V	0.021	5500
LGB1415-270K	27	1KHz/0.3V	0.023	5000
LGB1415-330K	33	1KHz/0.3V	0.027	4000
LGB1415-390K	39	1KHz/0.3V	0.029	4000
LGB1415-470K	47	1KHz/0.3V	0.031	4000
LGB1415-560K	56	1KHz/0.3V	0.035	3500
LGB1415-680K	68	1KHz/0.3V	0.041	3500
LGB1415-820K	82	1KHz/0.3V	0.052	3500
LGB1415-101K	100	1KHz/0.3V	0.056	3500
LGB1415-121K	120	1KHz/0.3V	0.069	3000
LGB1415-151K	150	1KHz/0.3V	0.078	3000
LGB1415-181K	180	1KHz/0.3V	0.096	3000
LGB1415-221K	220	1KHz/0.3V	0.147	2600
LGB1415-271K	270	1KHz/0.3V	0.175	2600
LGB1415-331K	330	1KHz/0.3V	0.192	2000
LGB1415-391K	390	1KHz/0.3V	0.210	2000
LGB1415-471K	470	1KHz/0.3V	0.240	2000
LGB1415-561K	560	1KHz/0.3V	0.315	1600
LGB1415-681K	680	1KHz/0.3V	0.360	1600
LGB1415-821K	820	1KHz/0.3V	0.460	1300
LGB1415-102K	1000	1KHz/0.3V	0.540	1300
LGB1415-122K	1200	1KHz/0.3V	0.660	1300
LGB1415-152K	1500	1KHz/0.3V	0.780	1000
LGB1415-182K	1800	1KHz/0.3V	0.990	1000
LGB1415-222K	2200	1KHz/0.3V	1.20	800
LGB1415-272K	2700	1KHz/0.3V	1.32	800
LGB1415-332K	3300	1KHz/0.3V	1.80	620
LGB1415-392K	3900	1KHz/0.3V	2.10	620
LGB1415-472K	4700	1KHz/0.3V	2.70	490
LGB1415-562K	5600	1KHz/0.3V	3.15	490
LGB1415-682K	6800	1KHz/0.3V	3.60	490
LGB1415-822K	8200	1KHz/0.3V	4.30	385
LGB1415-103K	10000	1KHz/0.3V	5.15	385
LGB1415-123K	12000	1KHz/0.3V	2.85	385
LGB1415-153K	15000	1KHz/0.3V	8.3	300
LGB1415-183K	18000	1KHz/0.3V	10.2	250
LGB1415-223K	22000	1KHz/0.3V	11.7	250
LGB1415-253K	25000	1KHz/0.3V	12.0	250
LGB1415-303K	30000	1KHz/0.3V	13.0	250
LGB1415-333K	33000	1KHz/0.3V	18.4	190
LGB1415-393K	39000	1KHz/0.3V	21.0	190
LGB1415-473K	47000	1KHz/0.3V	27.0	150

备注：以上规格仅供参考，更多规格可定制，如电流，Q值要求可另行测试，特殊规格，特殊要求可开模定制，支持加电流镍锌材质定制。